

Porotherm Wall solutions to meet the insulation requirements of Document Part L of the Building regulations.

All design and installation with Porotherm should be in accordance with British and European Standards, Codes of Practice, Building regulations and ancillary component manufacturers' guidance.

Thermal Performance

The ‘secret’ of the thermal insulation of POROTHERM clay blocks is the air trapped in the many small pores. When the added recycled materials e.g. sawdust, burn away (without residue), countless tiny holes are formed. These innumerable, interconnected pores and the carefully designed web and shell geometry intelligently reduce the flow of heat and thereby heat losses through exterior walls. Lambda values therefore vary according to the fired properties of the clay used in manufacture, density, recycled content and web geometry.

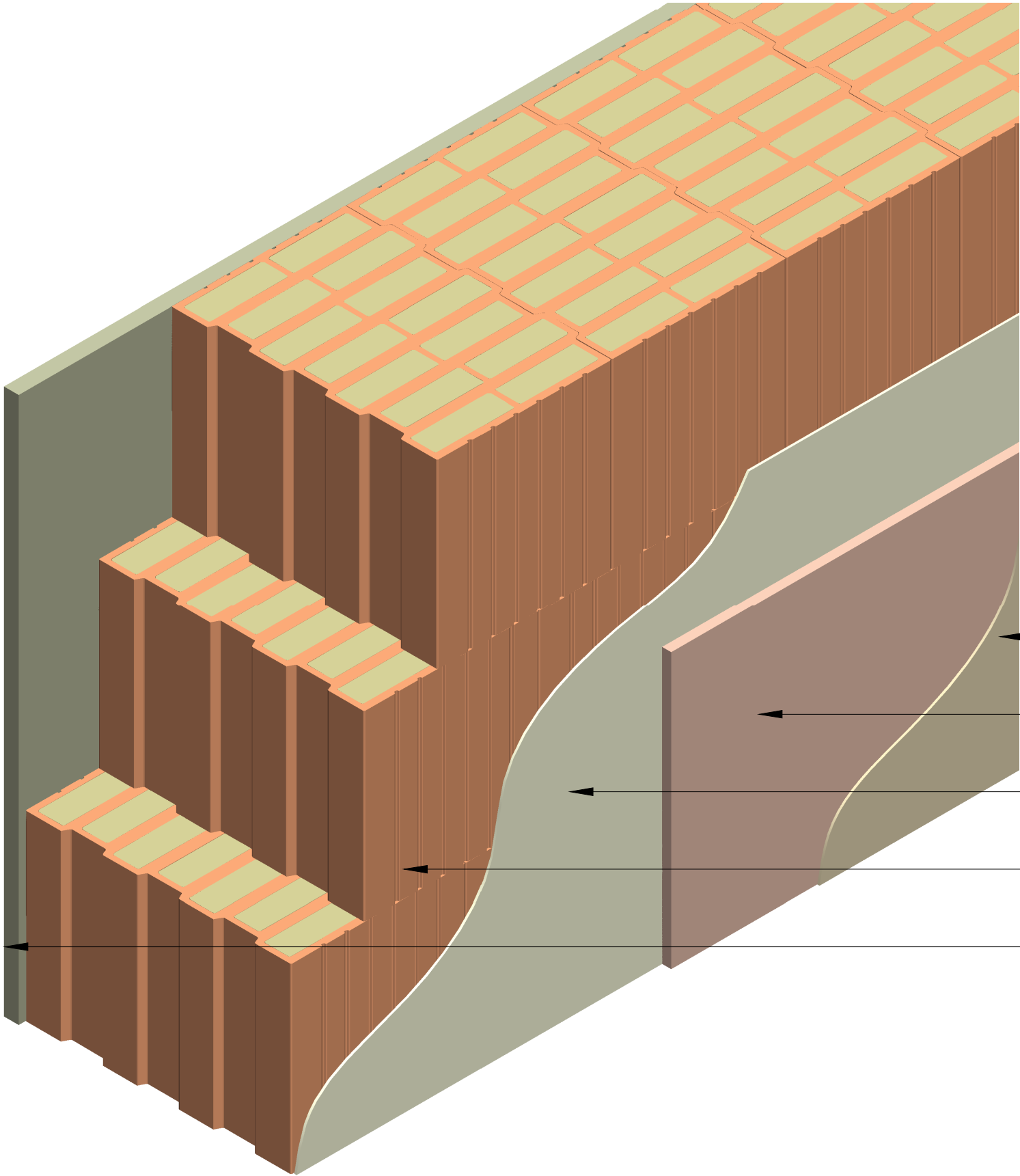

U = 0.18 W/m2K

**Monolithic T7-MW with Render (mm)**  
  
External Render (20)  
**Porotherm T7-MW** (365)  
Eco Parge (2)  
Dot/Dab Adhesive (15)  
Plaster board (12.5)  
Plaster skim (3)  
  
**Total wall width 417.5mm**

- Plaster skim
- Plasterboard on 10mm dabs
- Eco Parge
- Monolithic 365 block (T7-MW)
- Render

-	00/00/00	XXXXXXXXXXXXXXXX	XX	XX
rev:	date:	comment(s):	name:	check:



title:  
Monolithic u-value solutions  
365mm Monolithic

drg No:  
**WBR-PTN-365-UV03**

drawn:	check:	date:	scale:	rev:
JG	XX	26/02/21	1:5 @ A3	-



**Wienerberger Ltd**  
  
Wienerberger House, Brooks Drive,  
Cheadle Royal Business Park,  
Cheadle, Cheshire, SK8 3SA  
  
T: +44 (0) 161 491 8200  
E: design.uk@wienerberger.com